



## Zexcoil® TriBucker™ Wiring

The Zexcoil TriBucker consists of two individual Cores, that are intended to be wired individually, or together in series. Core 1 is a single-coil voice, Core 2 is a PAF HB voice, and the series combination of the two cores is very P90ish. The following Table and Figures present a range of wiring options to achieve any two of the available modes, or (preferably) all three modes on tap. Note that only the pickup switching is shown. The Volume and Tone pot wiring can be any standard wiring. In general, 500 kΩ pots are recommended. Options are shown to reverse “phase” (or more correctly: “polarity”) for compatibility with other manufacturer’s pickups.

Switching	Mode 1	Mode 2	Mode 3	Requirements	Recommendation
<b>2-way</b>	Core 2 (PAF)	Core 1 (SC)		1 dpdt <sup>1</sup> per pickup	Single push pot
<b>2-way Hot</b>	Core 1 + Core 2	Core 1		1 dpdt per pickup	Single push pot
<b>2-way Fat</b>	Core 2	Core 1 + Core 2		1 dpdt per pickup	Single push pot
<b>3-Way</b>	Core 2	Core 1	Core 1 + Core 2	2 dpdt or 1 4p3t <sup>2</sup> per pickup or 1 spdt <sup>3</sup> (or half of dpdt)	1 push pot (Vol) as a "Fat select" 1 push pot (Tone) as a "split" or 1 On/On/On 4p3t to switch between all three modes directly or 1 On/Off/On dpdt to switch between all three modes directly (can also be ganged for 2 pickups on a single switch)
<b>Notes:</b> 1. "dpdt" refers to a double pole, double throw switch, such as a typical push-pull, push-push, or mini toggle					
2. "4p3t" refers to a 4 pole, triple throw switch. Available from AllParts.					
3. "spdt" refers to a single throw, double pole switch					

Table 1: Switching Options for the Zexcoil TriBucker

Lawing Musical Products, LLC  
416 Papermill Road  
Newark, DE 19711  
302-533-7548  
[www.zexcoil.com](http://www.zexcoil.com)



The White and Green wires are hot and ground respectively for Core 1, and the Red and Black wires are hot and ground respectively for Core 2. The bare shield wire should be grounded in all cases.

For the most versatility, we highly recommend 3-way wiring. The simplest 3-way scheme is with an on-off-on mini toggle switch as shown in Figure 1. A switch can be dedicated to each pickup (to maintain individual switching), or both pickups can be “ganged” on a single dpdt on-off-on switch, giving a single switch that throws the entire guitar into 3 different pickup modes. While probably the most convenient and intuitive, this “ganged” switching option does limit the pickup combination possibilities.

For the classic 4 knob control layout of humbucker guitars, we recommend the control scheme illustrated in Figure 2. This layout utilizes four push/pull pots. Each pickup is controlled with two push/pull switches. One switch is a “master split” that activates Core 1, putting the pickup in single coil mode regardless of the position of the second switch. The second push/pull switch selects between PAF HB and P90 mode when the master split is inactive.

### On/Off/On Mini Toggle

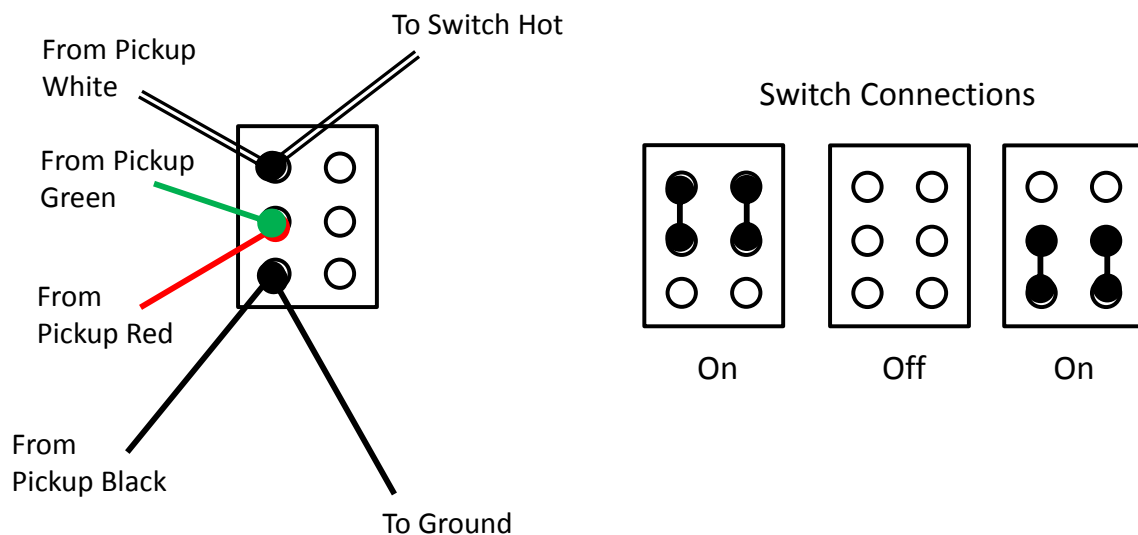
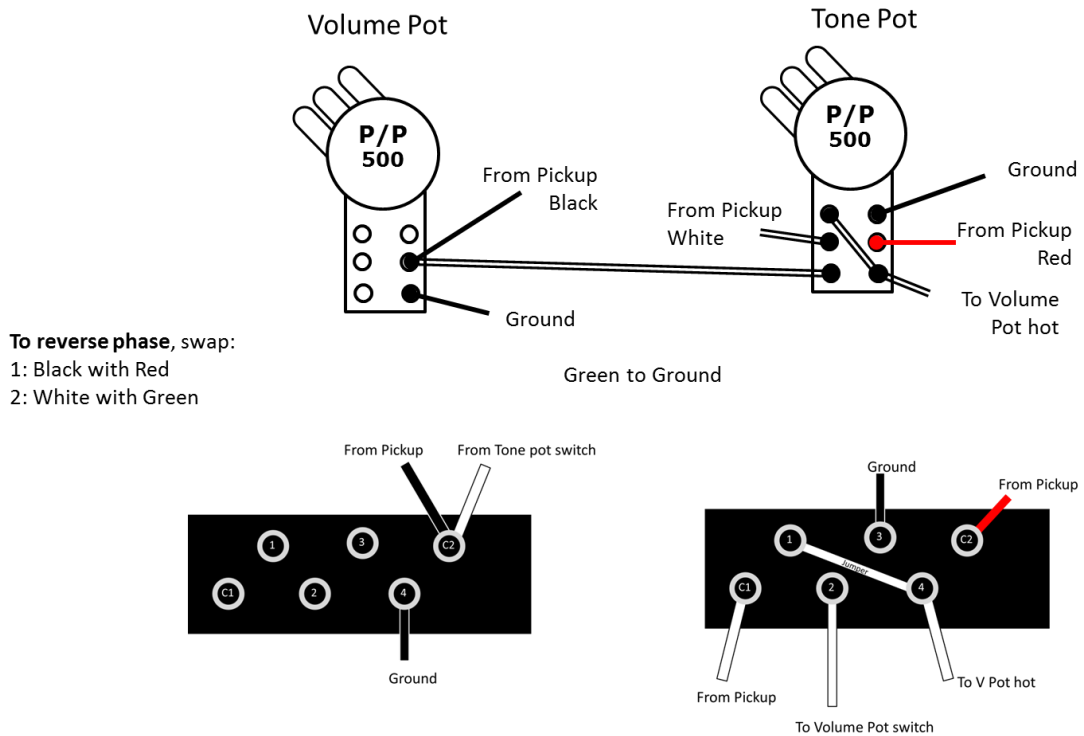

Figure 1: 3 way switching with a single spdt (or one side of a dpdt) switch. Two pickups can be ganged on a single dpdt switch, just wire the second pickup to the other column of connections, exactly as the first. To reverse polarity, swap the hot and ground connections.

Must use On/Off/On switch, not On/On or On/On/On!



Tone pot acts as a “Master Split”: when tone pot switch is UP, Single Coil mode is engaged regardless of the position of the Volume pot switch.  
 Volume pot selects between PAF (DOWN) and P90 (UP) modes.

Figure 2: 3-Way Switching with 2 dpdt Switches

Push Pot or Mini Toggle

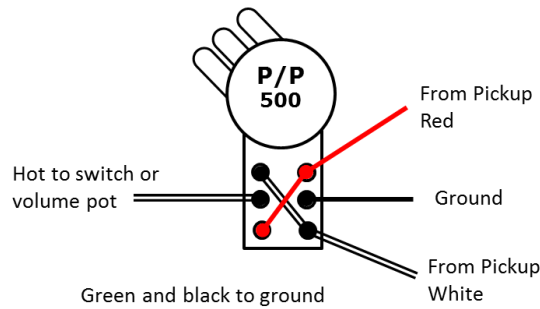

Down (HB)	Up (Single Coil)	
Red: hot	White: hot	
Black: ground	Green: ground	<b>To reverse phase, swap:</b>
White: ground	Red: ground	1: Black with Red
Green: ground	Black: ground	2: White with Green

CTS Push-Pull

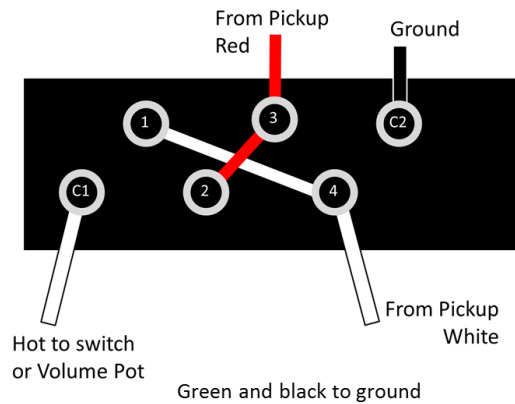

Figure 4: 2-way Standard Switching (Core 1 or Core 2)



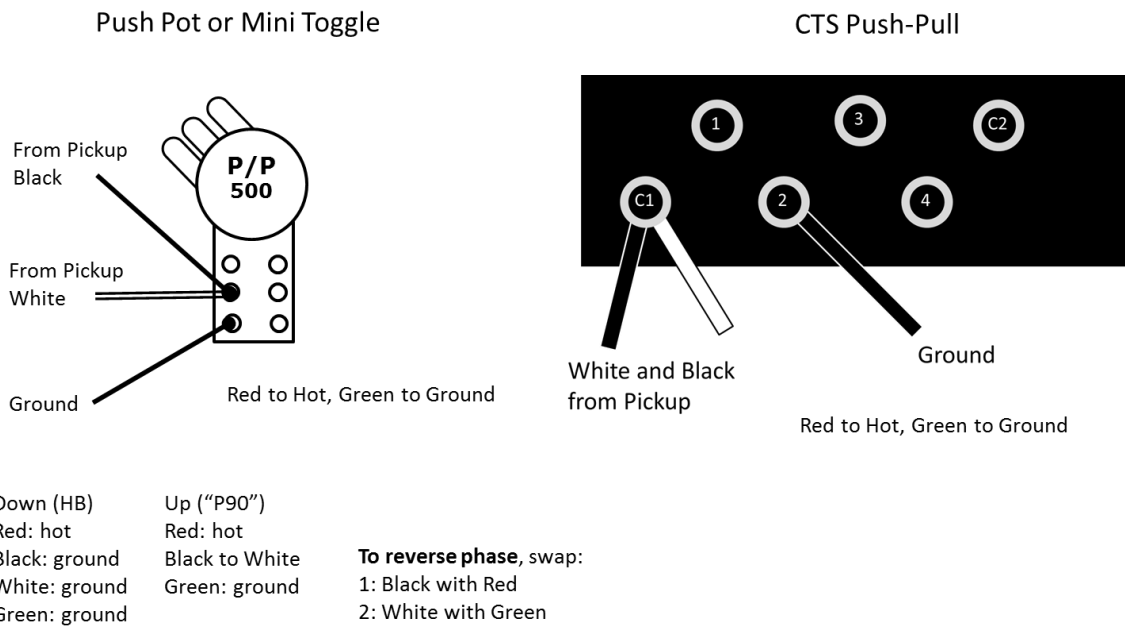
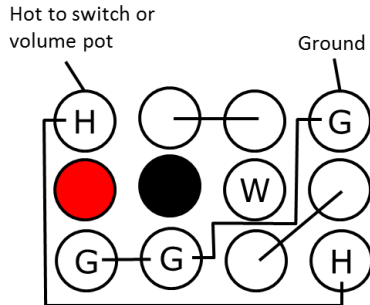

Figure 6: 2-way "Fat" Switching (Core 2 or both Cores combined)

Zexcoil Standard Wiring



White, Red & Black from pickup to posts as show above. Green to ground

To reverse phase wire as below

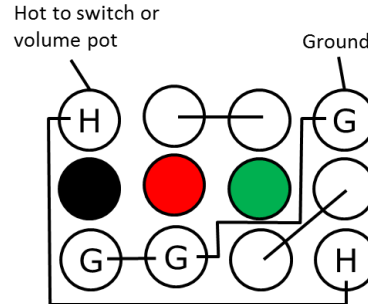

Black, Red & Green from pickup to posts as show above. White to ground

- Position 1 = Core 1 + Core 2 ("P90")
- Position 2 = Core 2 (PAF HB)
- Position 3 = Core 1 (Single)

Switch Connections

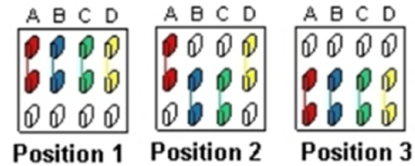

Figure 7: 3-Way Switching with a single 4p3t Switch  
 (Note: make sure and test the switch connection directionality before wiring – it's not the same upside down!)

Scott Lawing  
 Lawing Musical Products  
[scott@zexcoil.com](mailto:scott@zexcoil.com)  
 302 533 7548/302 766 0505

Revision 1, 1/7/2020